

# Malusi Needs : Nursery

- ③ **Park + Play ground kids**
- Formal meeting space**
  - ↳ Stones + Seating + benches.
- Clean up**
  - ↳ garbage
  - ↳ tree branches
- Public WC**
  - ↳ Cleaning Staff → \$?
- owner spa** (job recruiting)
- Resort** → Quad biking → horse riding → obstacles course → skateparks → shops.
- Spa** - inside old building.
- mini spa, mini pool, chilling spot, activities

## How can the Nursery be changed/transformed to be an amazing, relaxing, safe and beautiful space?

**festival** **Apollo light**

<p><b>Mentions:</b></p> <ul style="list-style-type: none"> <li>- Pool</li> <li>- Play area</li> <li>- Braai place</li> <li>- Exercise</li> <li>- Activities</li> </ul> <p><i>↳ social inclusiveness → Link with MYDS</i>  <i>↳ Self defense classes → source people</i>  <i>↳ Gym indoor vernacular architecture.</i>  <i>↳ out door gymnasion in Park.</i>  <i>↳ Yoga classes</i>  <i>↳ Pool table</i>  <i>↳ under cover → be taken down.</i></p>	<p><b>Prompting:</b></p> <ul style="list-style-type: none"> <li>- Safer → cutting trees</li> <li>- Landscaping</li> <li>- Meeting Space (amphitheatre)</li> <li>- Public WC</li> </ul>
--	--

**Vegetable gardens.** (Tuku agriculture, who can start the garden, Government, Markets, Sell leftover)

**Picknick spot.** (Perform it, hall @ MYDS)

**RAIN WATER RETICULATION**

**Theater class** (Perform it, hall @ MYDS)

**Safety** (Security, Guards, Patrol → Lock out.)

**Landscaping** (Sensitive landscaping, Pathways, Low maintenance)

**School built**

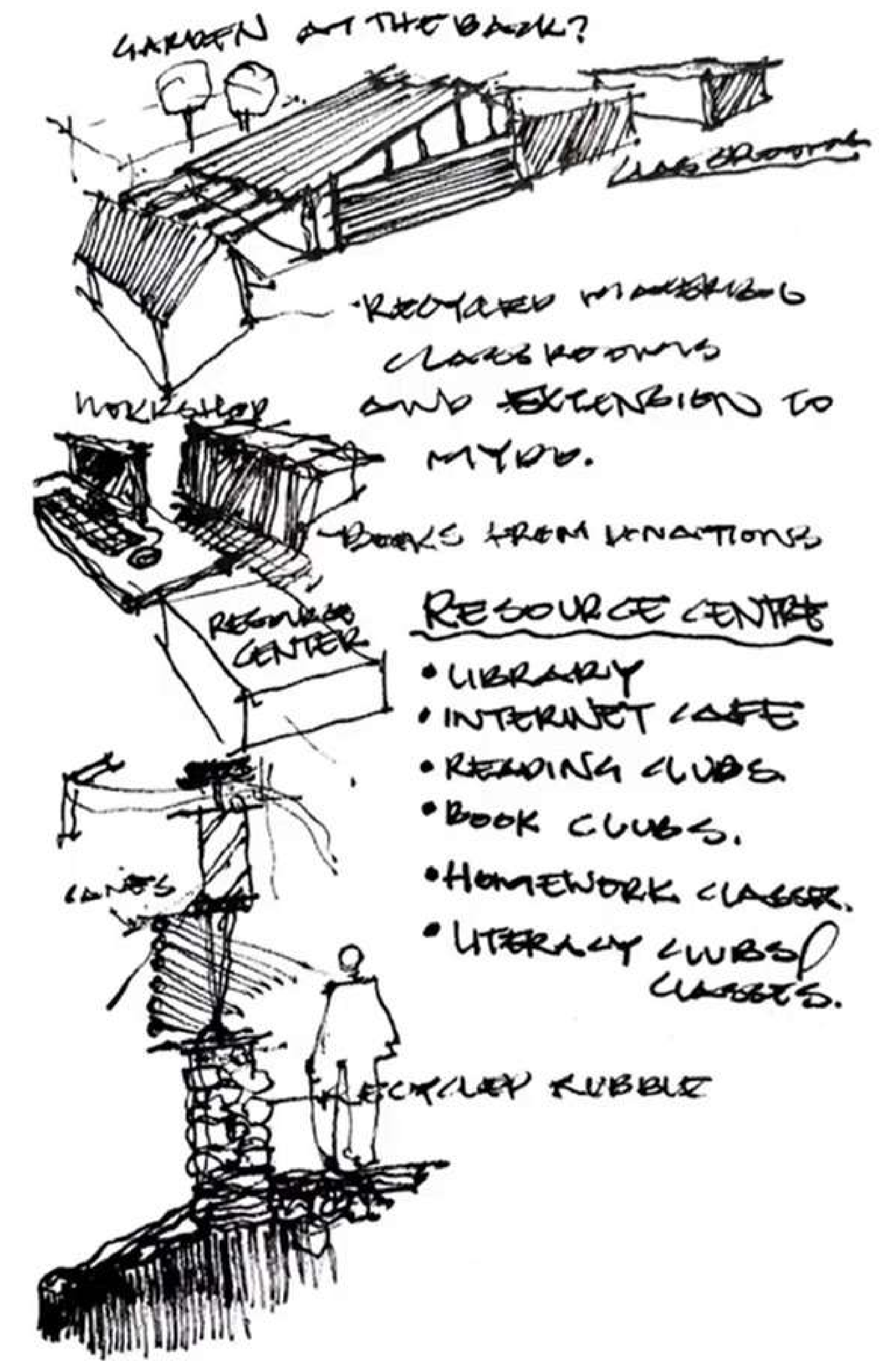

**RESULTS**  
33  
(Unit for Urban Citizenship, 2024)

Department of Architecture, University of Pretoria and Co-creating Wellness Studio, 2024

# Design Approach

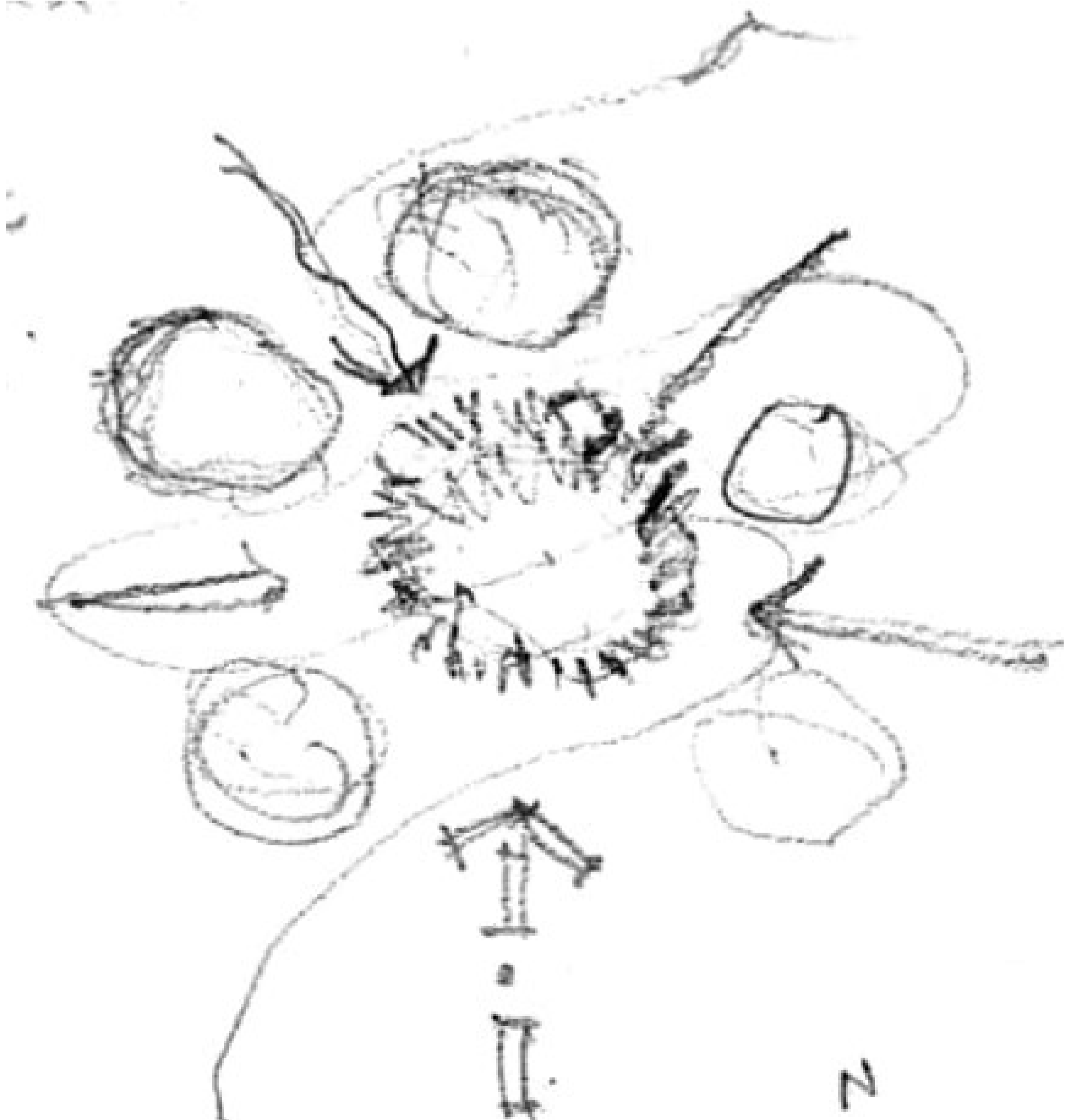
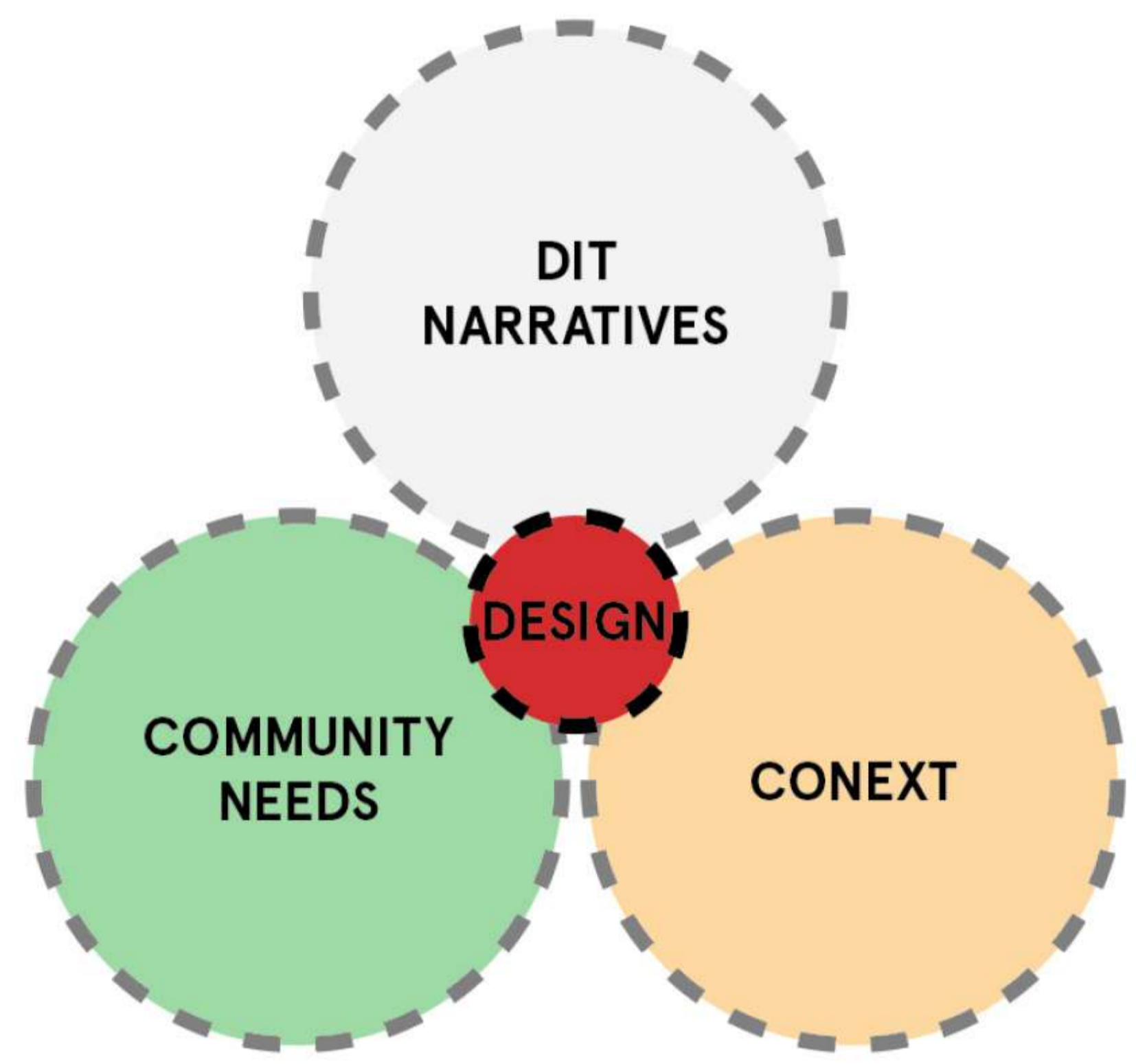

1 SPACES



2 PLANTS



3 MATERIALS + FINISHES

FINISHES



4 INTANGIBLE LAYERS



# SYSTEMS

## Hydrological Systems

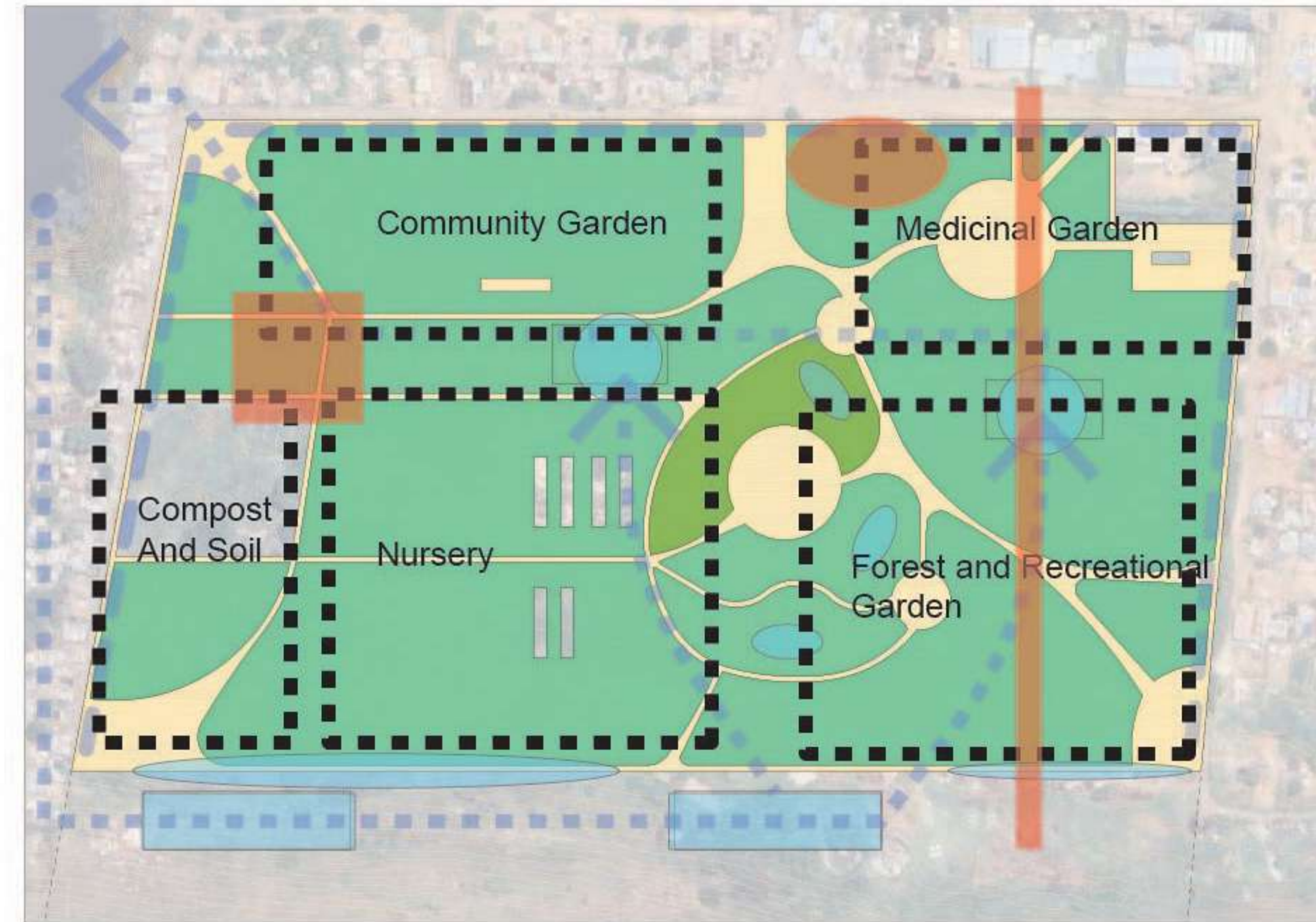
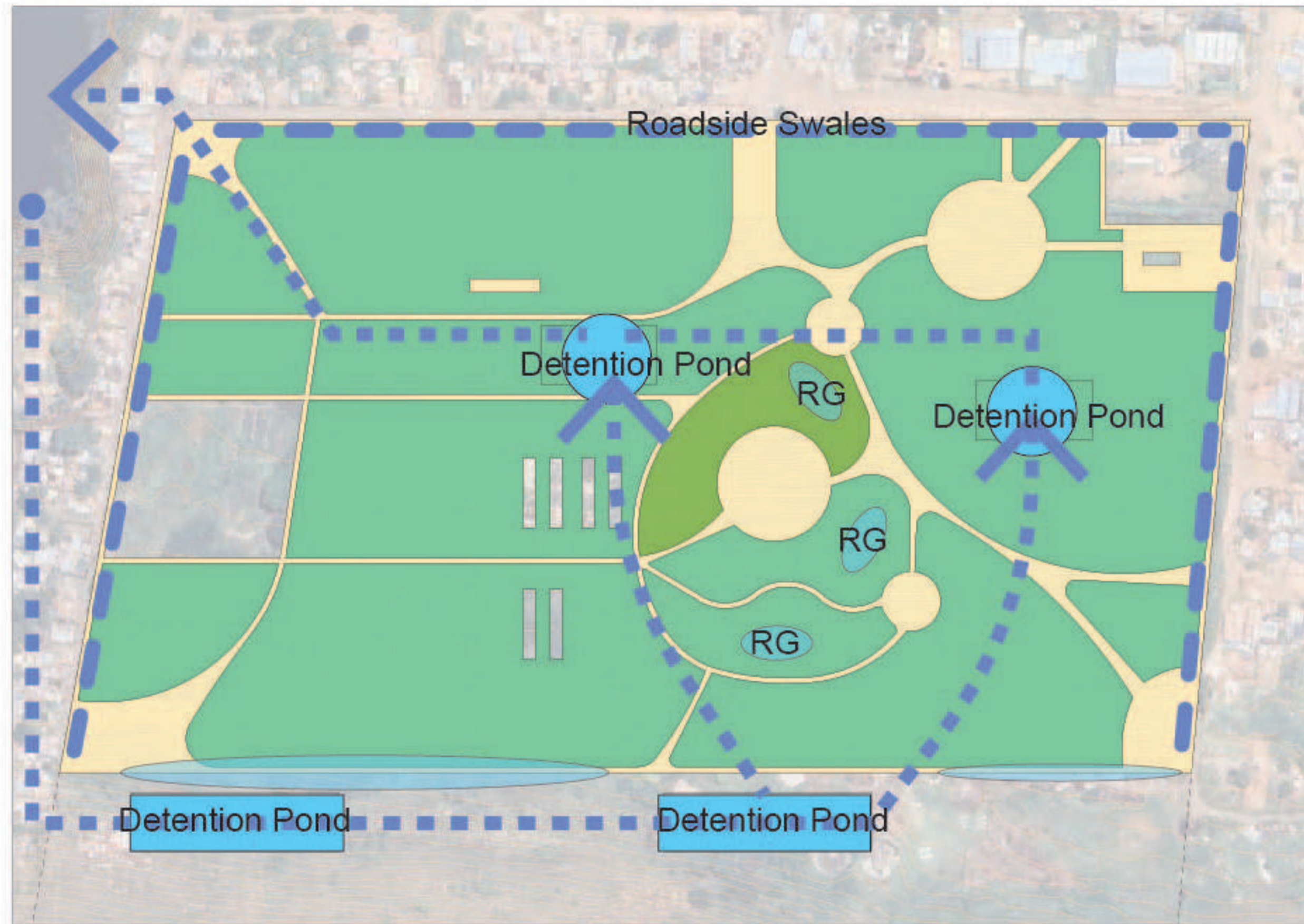

## Systems

### Retention Ponds

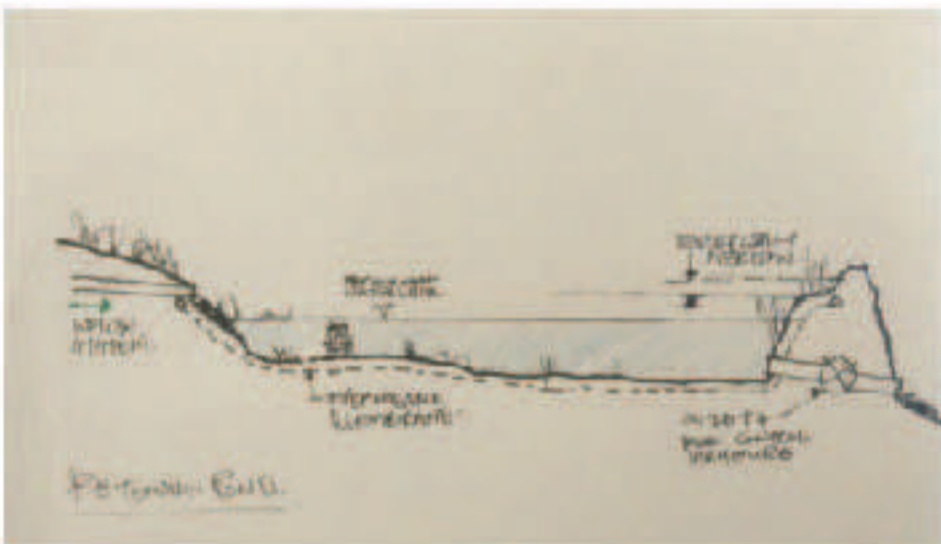

Retention ponds, also referred to as 'retention basins', have a permanent pool of water in them (Debo & Reese, 2003; Mays 2001). They are generally formed through the construction of a dam wall (or walls) equipped with a weir outlet structure. The maximum storage capacity of retention ponds is larger than their permanent pond volume. Stormwater coming into the pond is mixed with the permanent pond water and released over the weir at a reduced rate (Field & Sullivan, 2003; NCDWQ, 2007). Retention ponds are usually capable of handling relatively large quantities of stormwater runoff (Woods-Ballard et al., 2007). The permanent pond volume can be utilised as a source of water for various non-potable purposes. Retention ponds generally provide a medium to high pollutant removal capacity (Woods-Ballard et al., 2007). They normally utilize a combination of sedimentation, filtration, infiltration and biological uptake processes to remove pollutants from stormwater runoff (Stahre, 2006).

### Rain Gardens (RG)

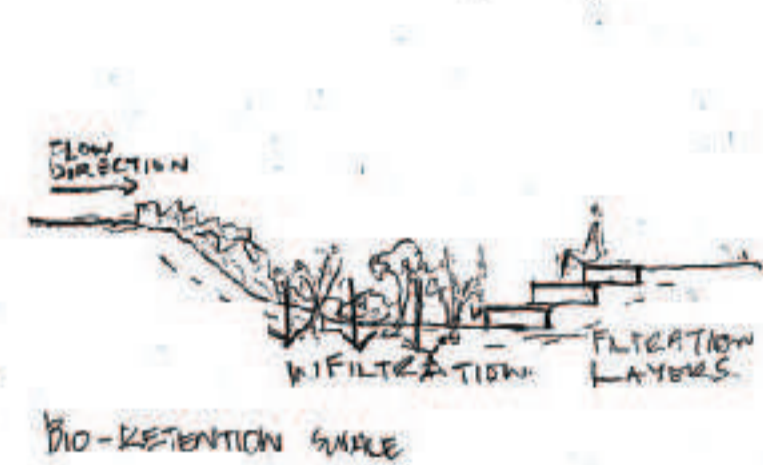

Definition: Bio-retention areas, also referred to as 'rain gardens' or 'bio-retention filters', are landscaped depressions typically employed to manage the runoff from the first 25 mm of rainfall by passing the runoff through several natural processes. These processes include filtration, adsorption, biological uptake, sedimentation, infiltration and detention. Bioretention areas normally incorporate a series of small stormwater management interventions such as grassed strips for infiltration, temporary ponding areas, sand beds, mulch layers and a wide variety of plant species (Endicott & Walker, 2003).

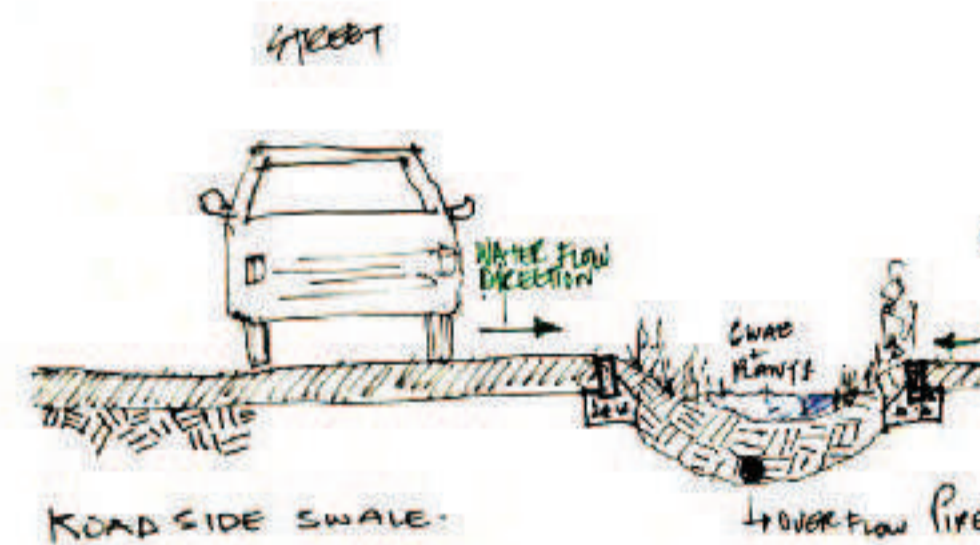

Swales are generally suitable for road medians and verges, car parking runoff areas, parks and recreation areas (Environment Protection Authority Melbourne Water Corporation, 1999). They should be designed to meet two chief stormwater management processes, namely, (1) flow conveyance requirements, and (2) effective stormwater pre-treatment (Debo & Reese, 2003).

## Systems

The nursery is used to grown plants for the site, which are planted on all gardens, waste plants are managed on the compost and soil area to extract seeds and create compost.

### Healthy trees to be retained Indicated in red



# SCETCH PLAN

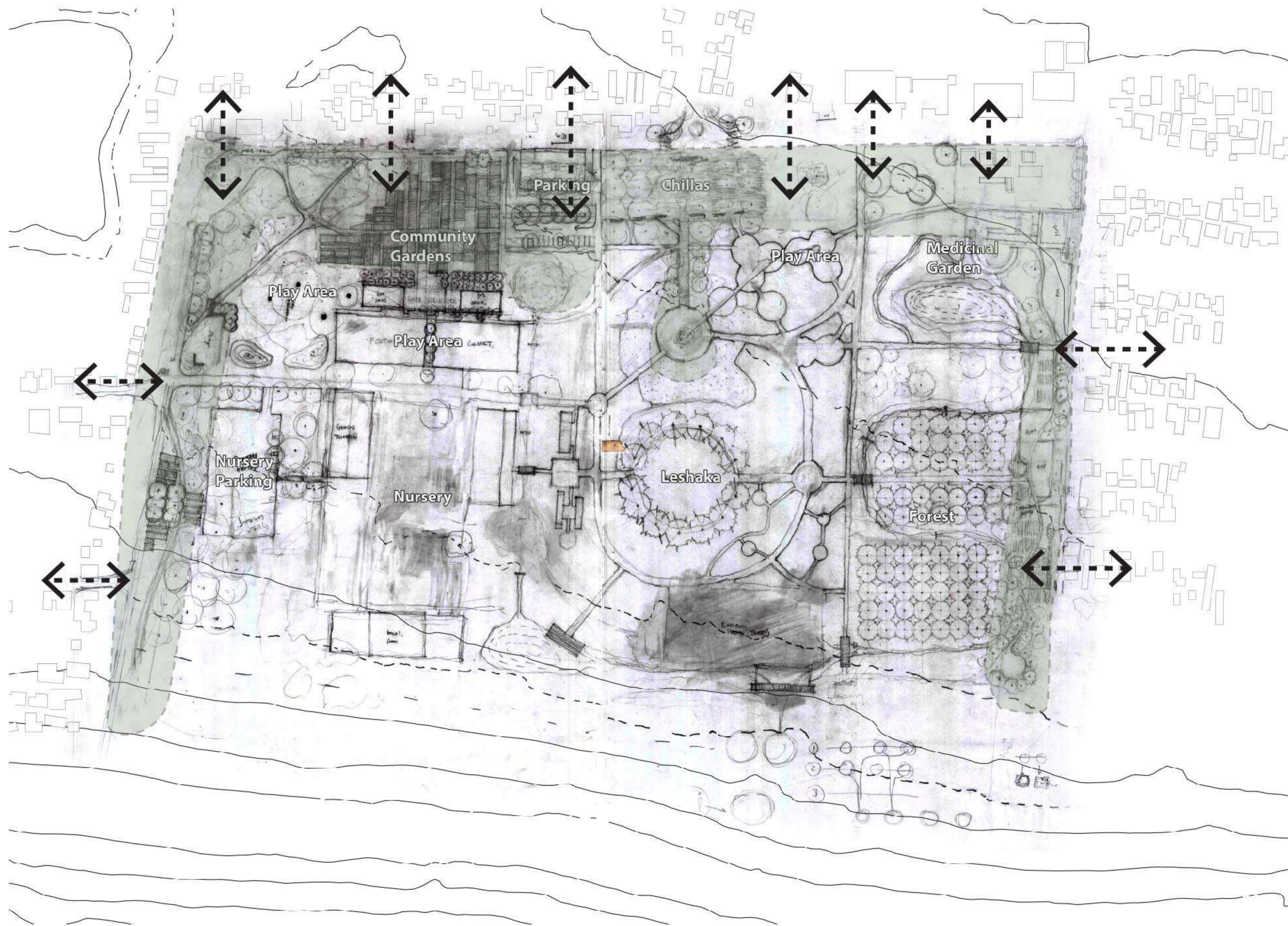

# DESIGN PLAN

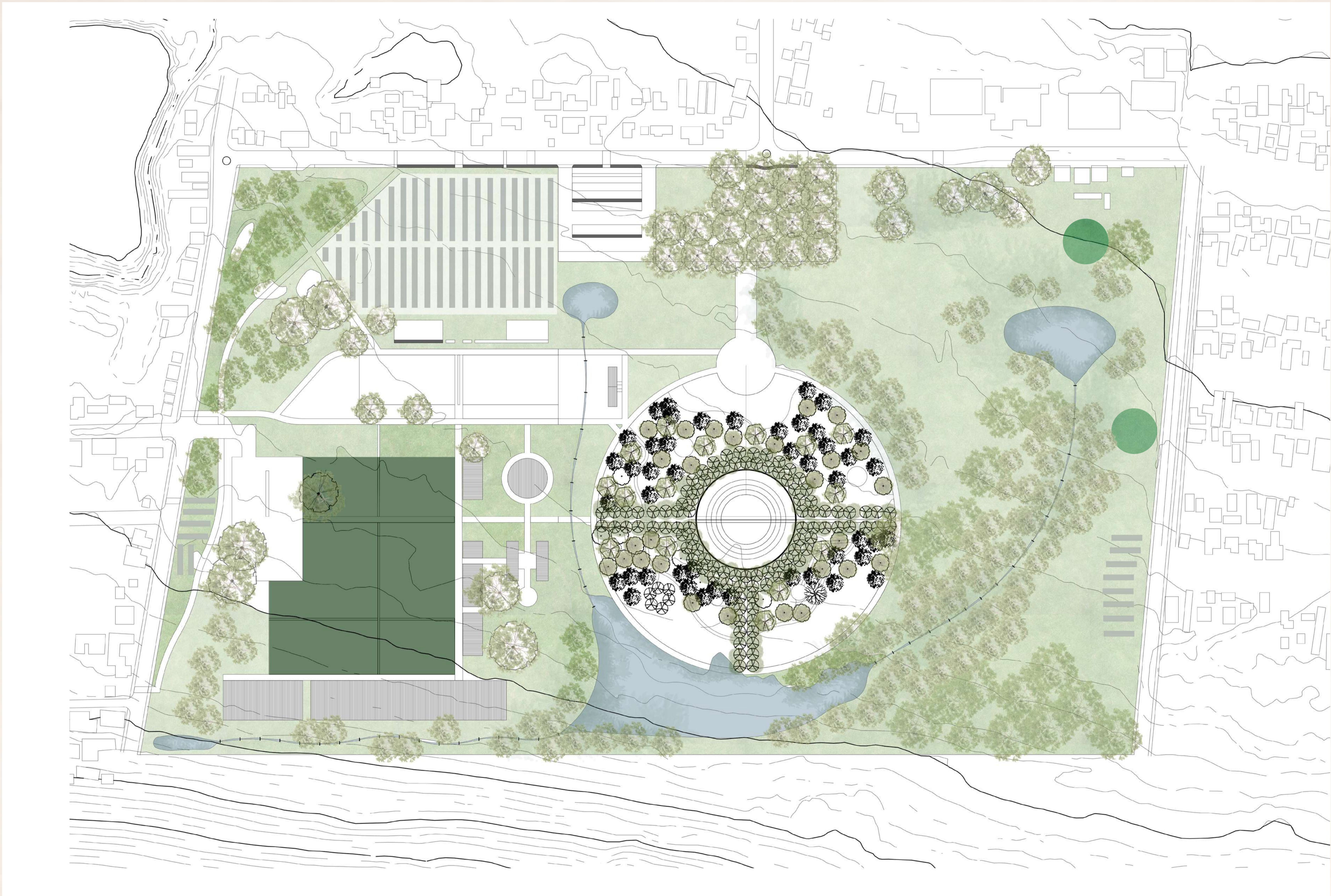

# DESIGN SECTIONS

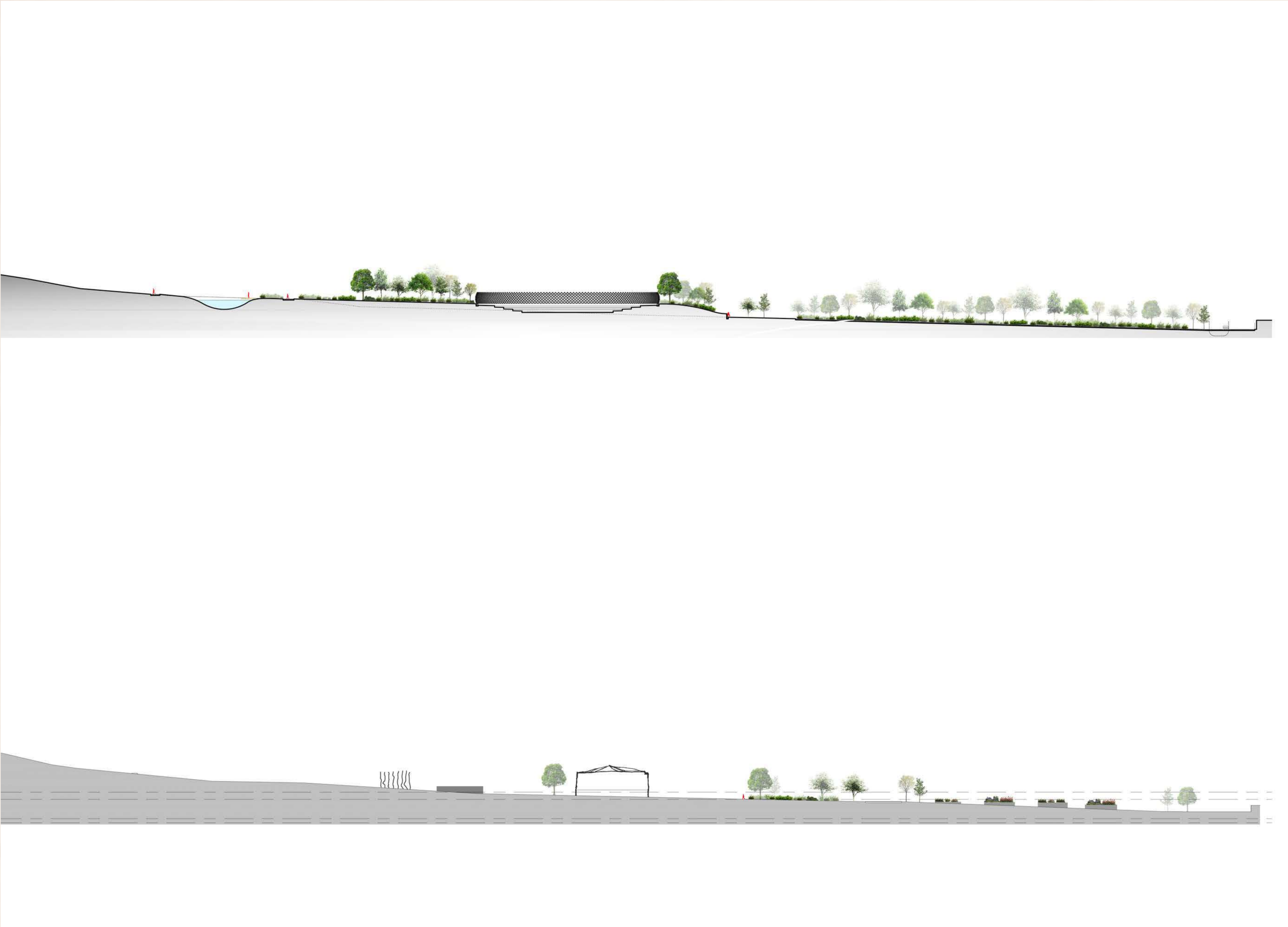

# DESIGN RENDERS



# DESIGN RENDERS



# DESIGN RENDERS

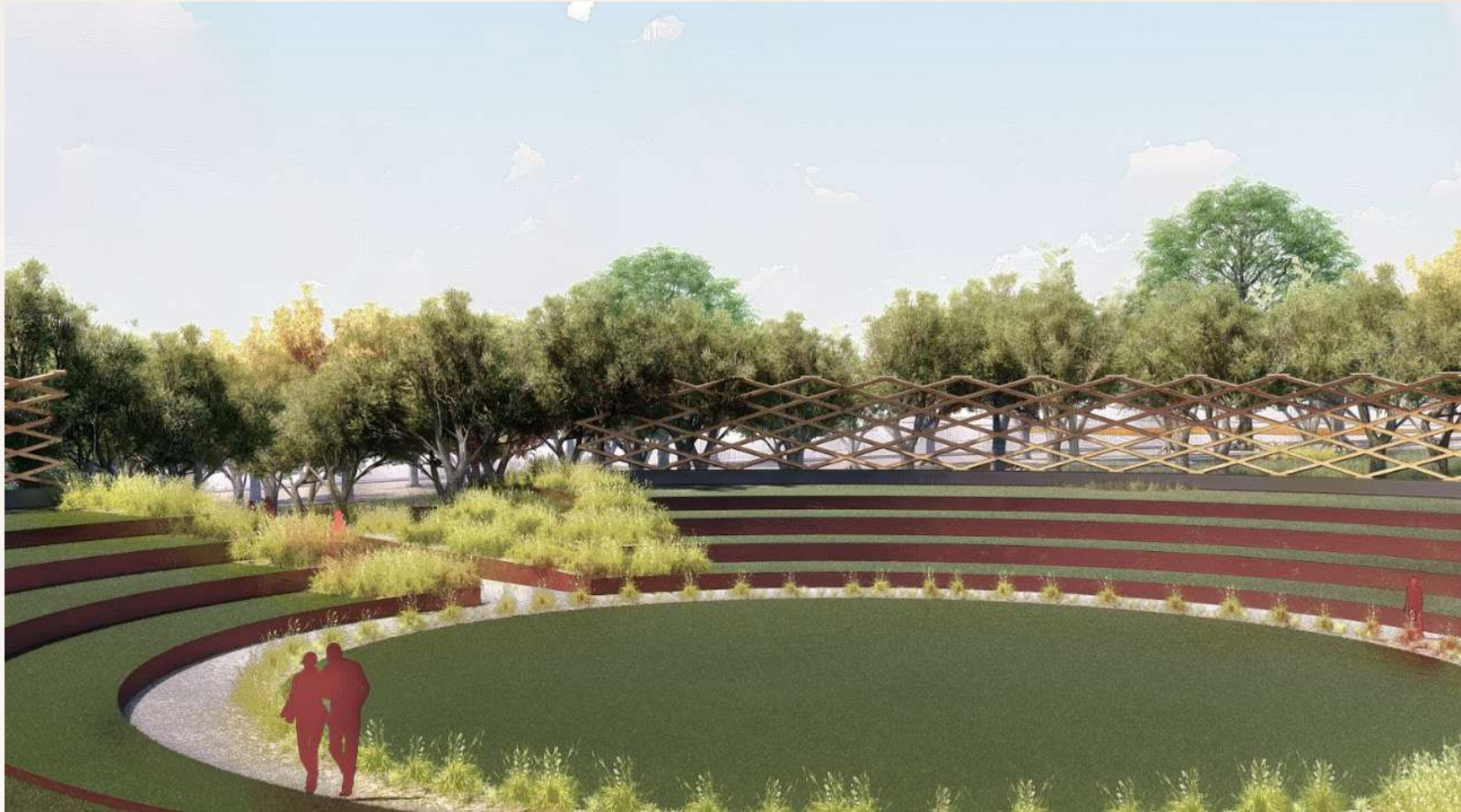

# CPD UNIT 4: TECHNICAL DOCUMENTATION AND DEVELOPMENT

**Concept and Detail Approach:** The project is inspired by indigenous architecture of the nguni village, the village is not only an ordering tool but inspires the materials, form and details. The main theatre space is inspired by the kraal. It's the main multi-functional indigenous sporting space, it re-imagines a kraal in an Urban Park, The retention pond acts as a source of life for the pond while offering a deck where talking to the ancestors can take place.

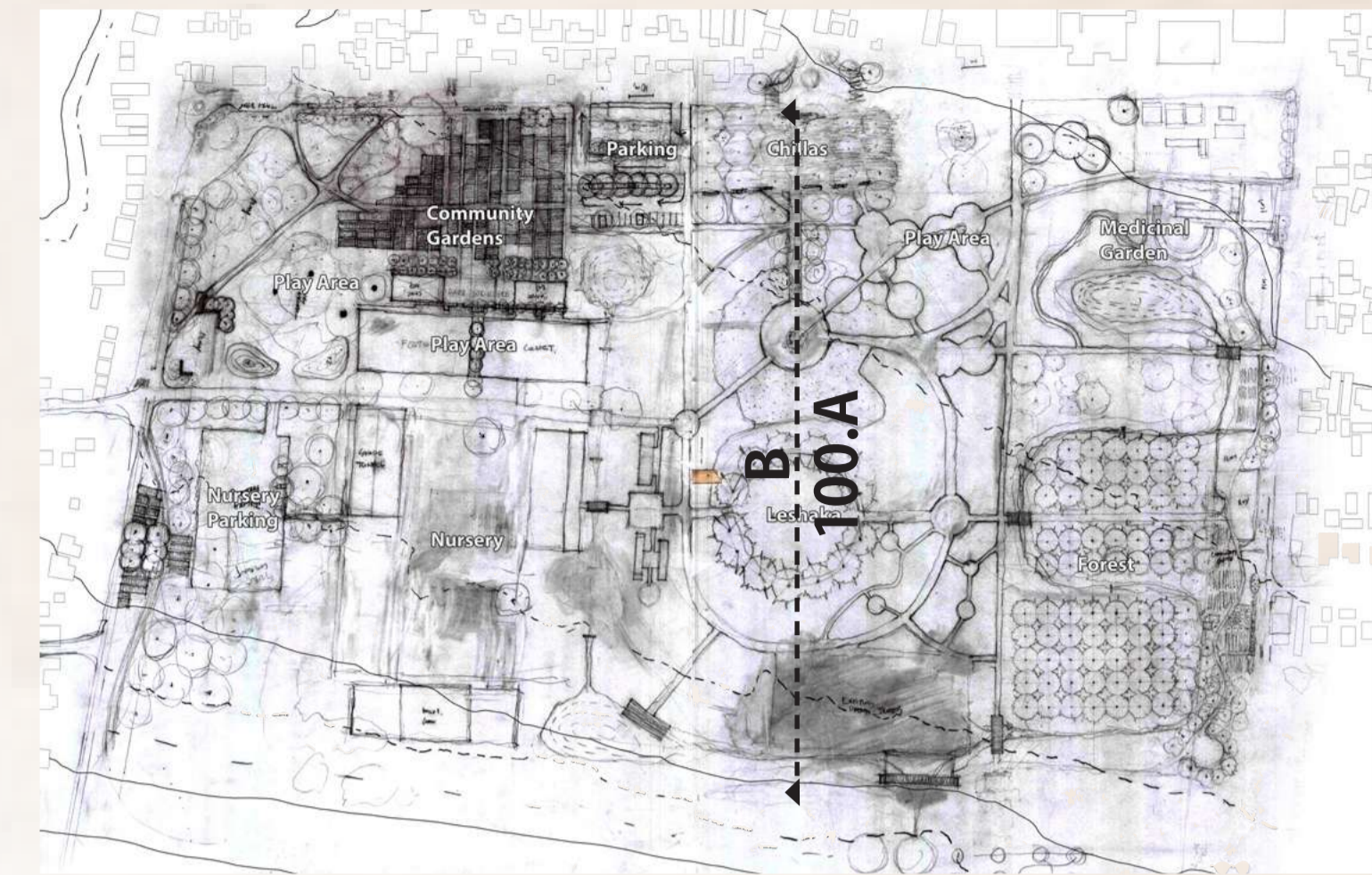

Ref Plan

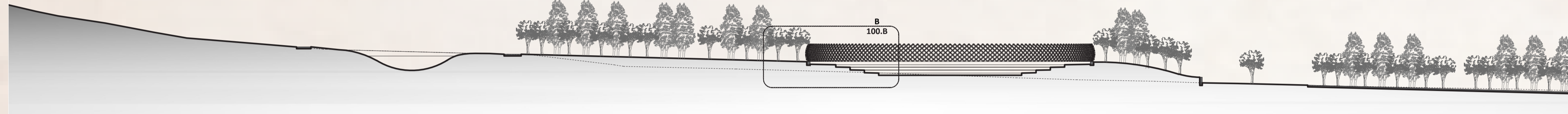

B 100.A LONG SECTION SCALE 1:500

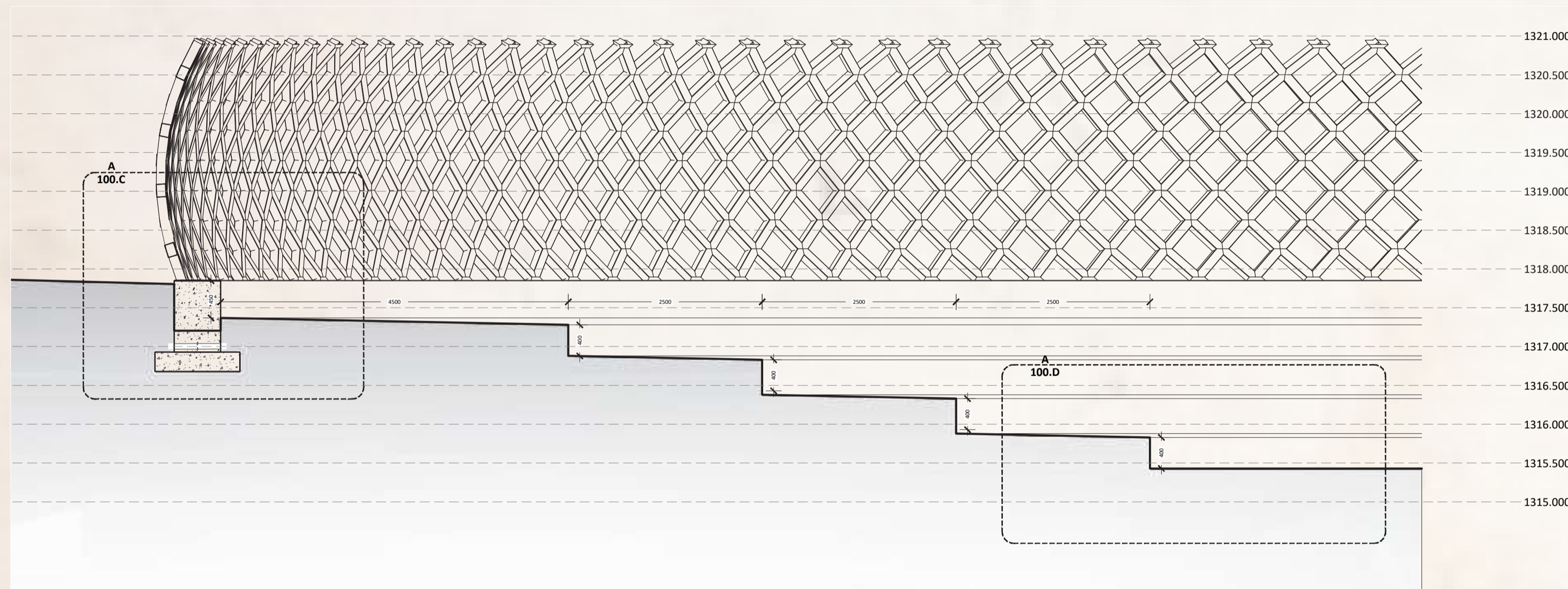

B 100.B INDIGENOUS SPORTS THEATRE SECTION SCALE 1:50

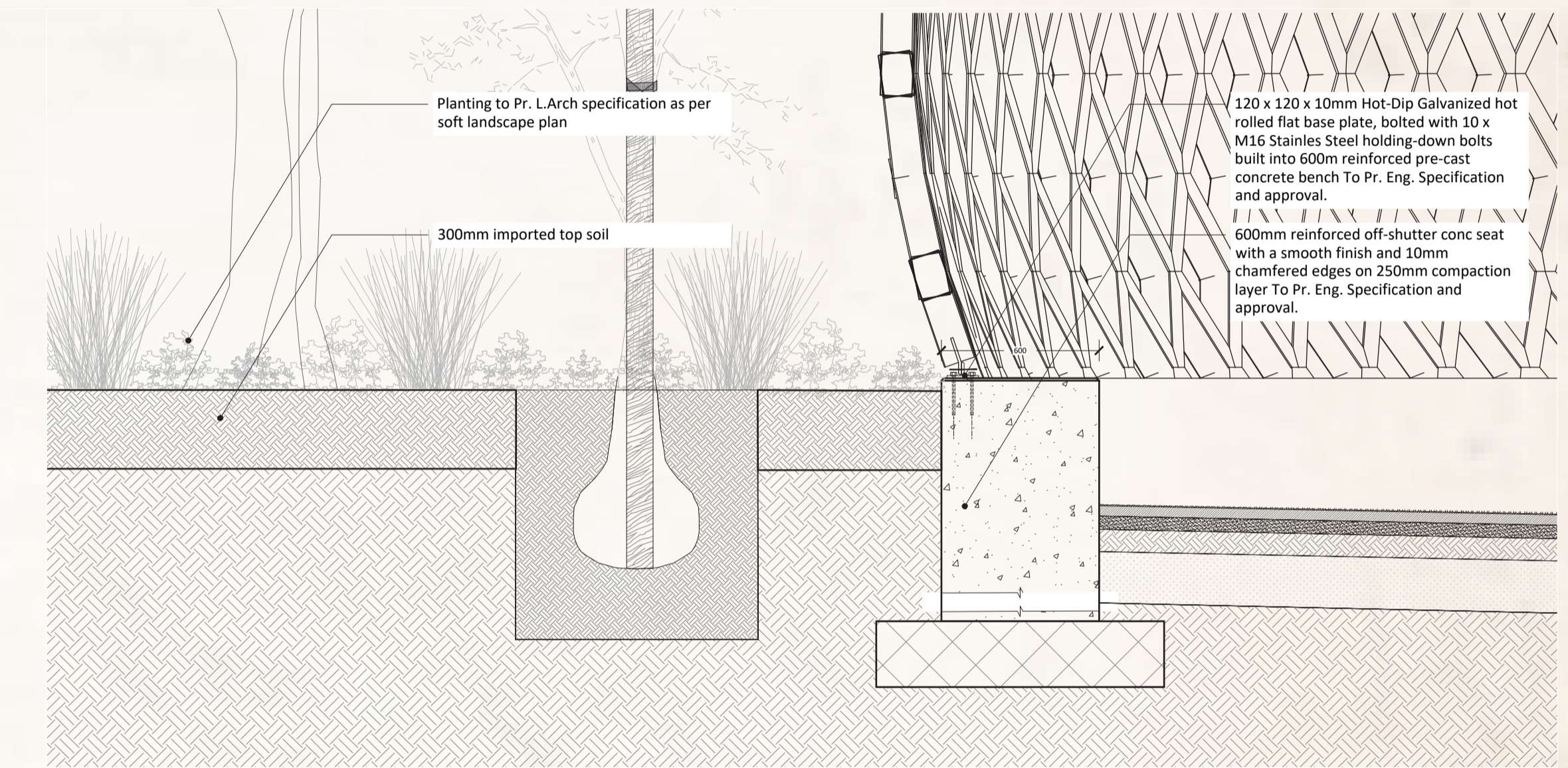

B 100.C THEATRE CONC BENCH SCALE 1:20

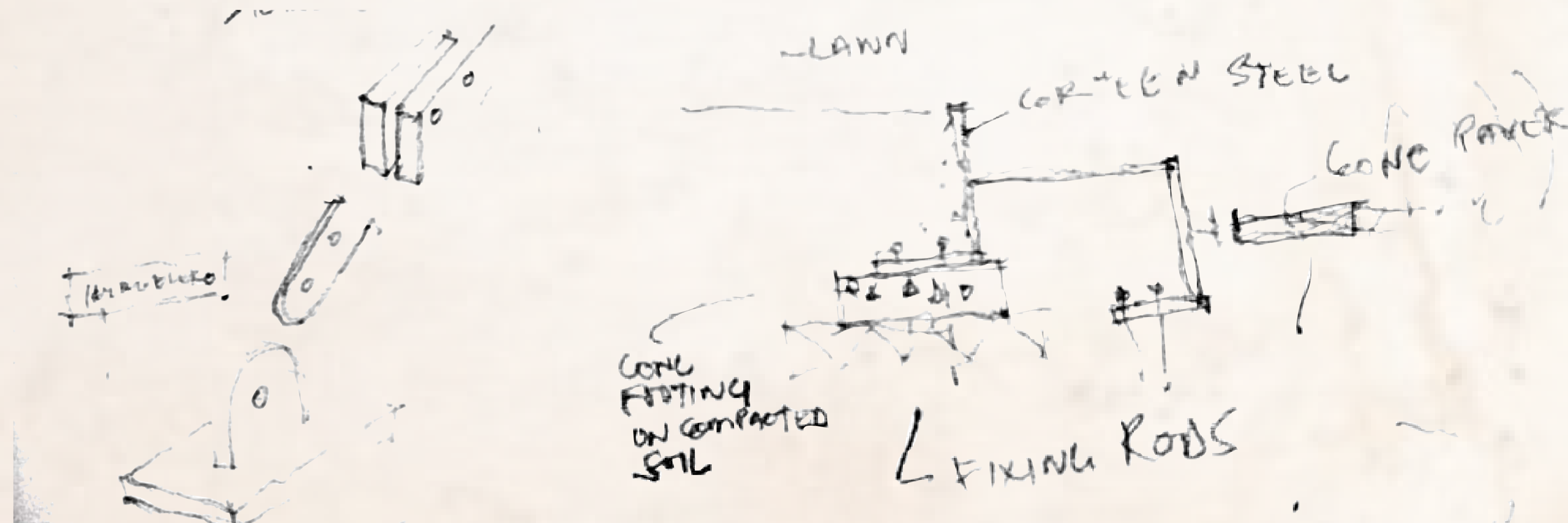

Exploration Sketches

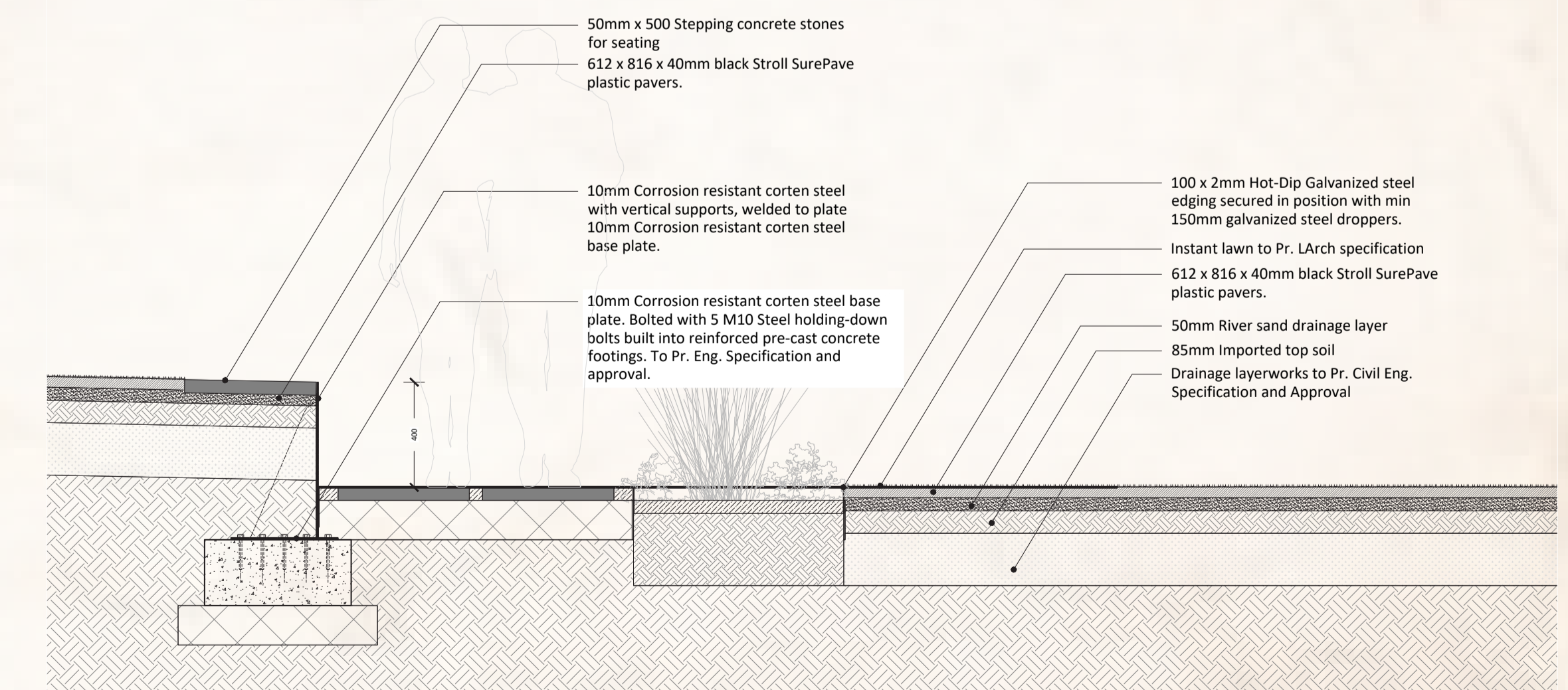

B 100.D THEATRE SEATING SCALE 1:20

# CPD UNIT 4: TECHNICAL DOCUMENTATION AND DEVELOPMENT

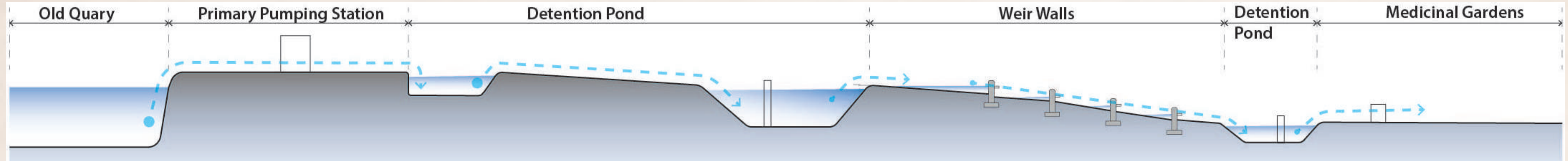

Diagrammatic Section

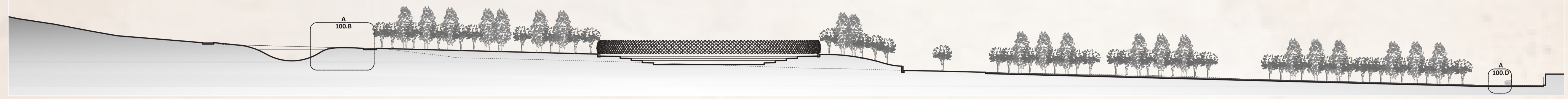

A 100.A LONG SECTION SCALE 1:500

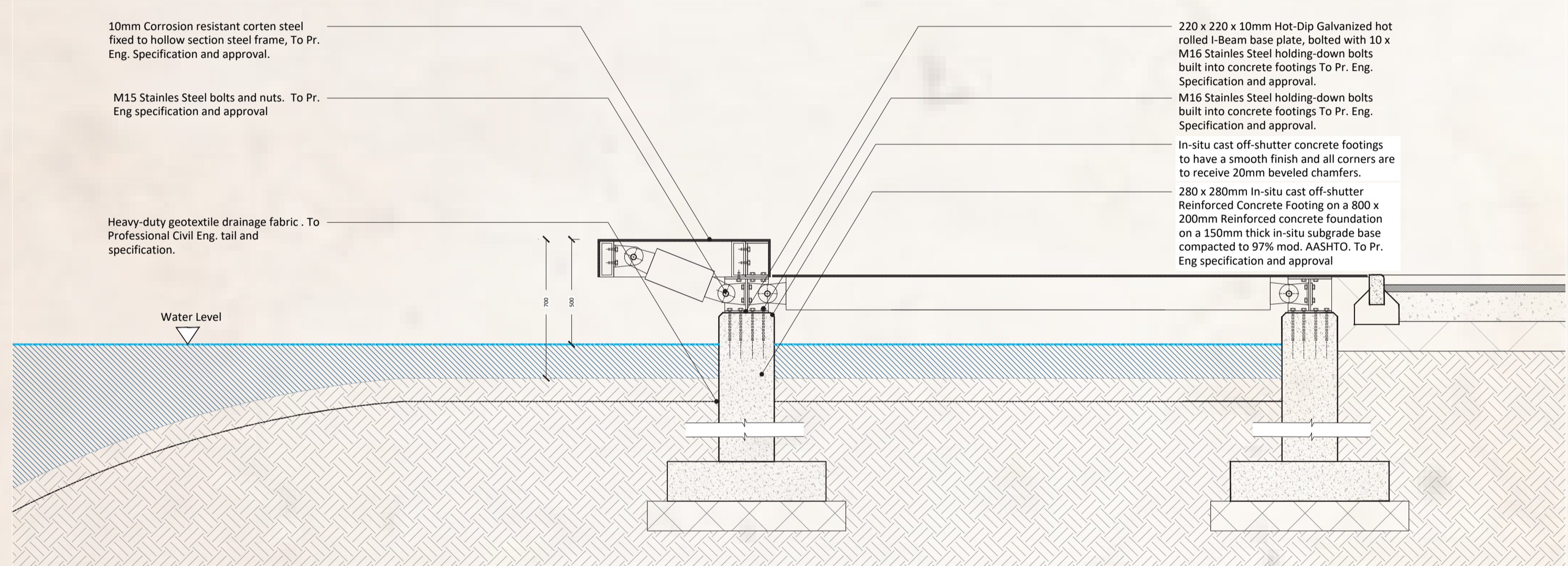

A 100.B SECTION THROUGH THE DECK SCALE 1:50

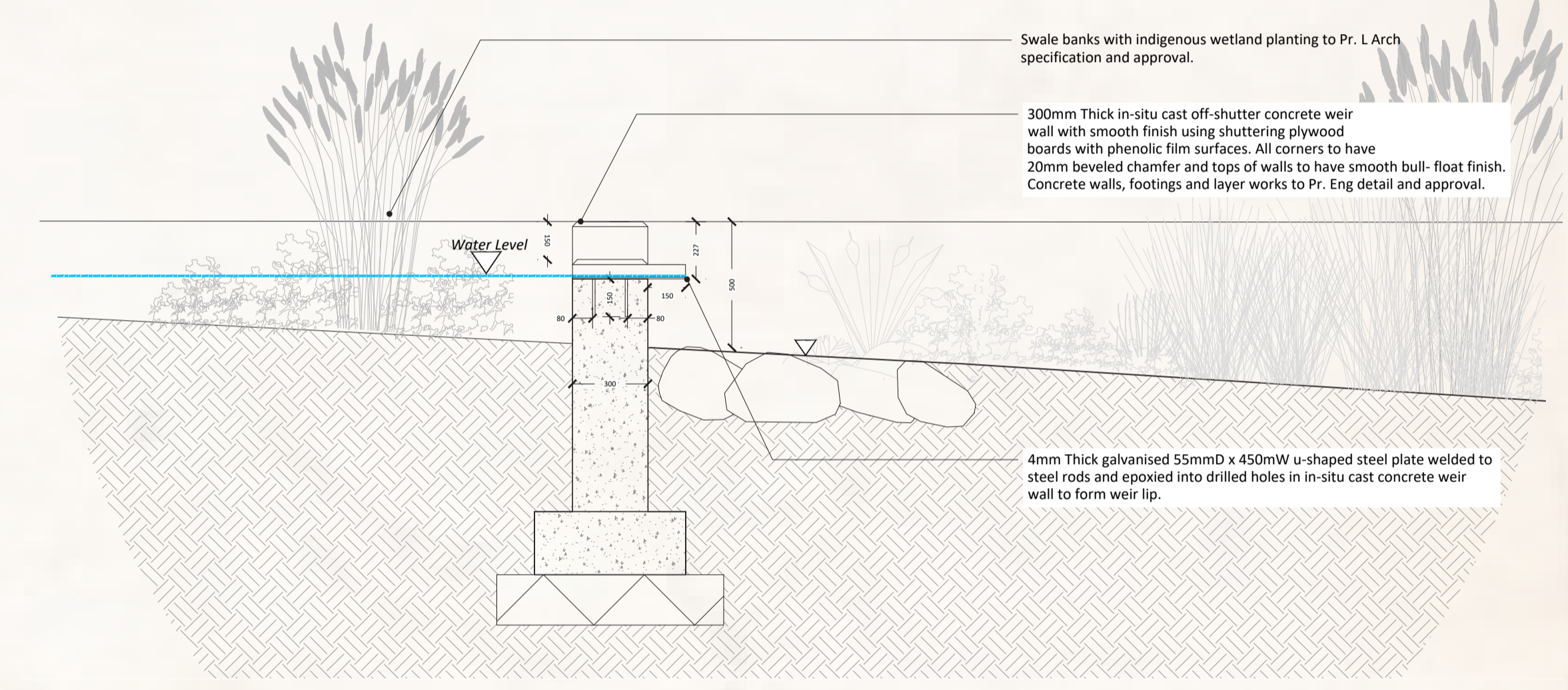

A 100.C WEIR WALL DETAIL SCALE 1:20

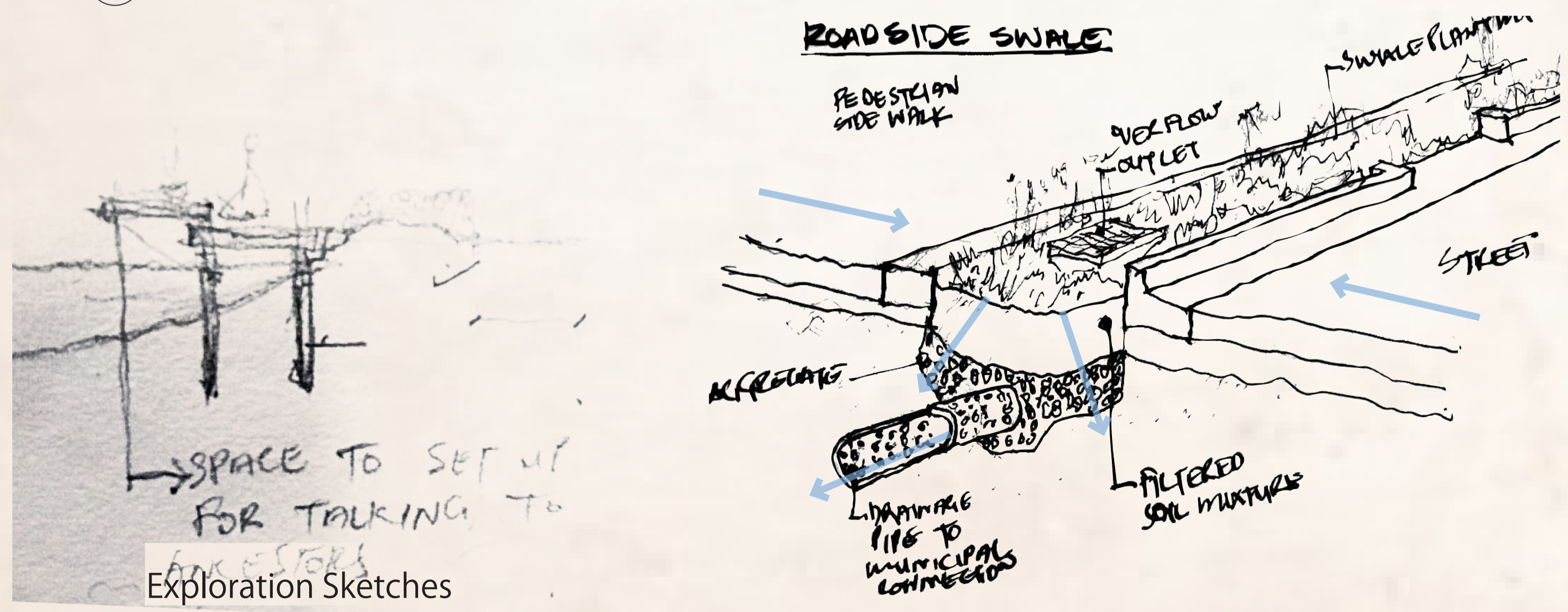

Exploration Sketches

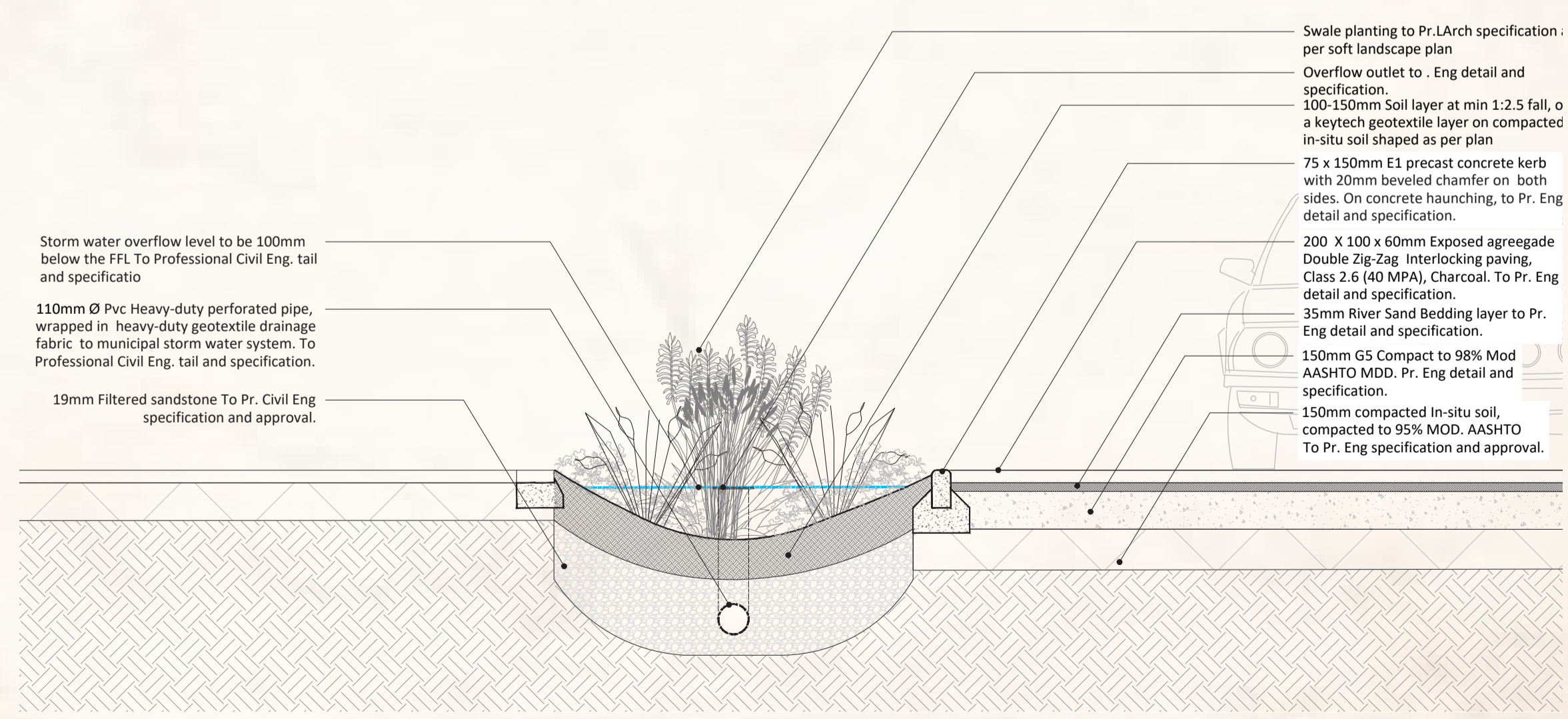

A 100.D ROAD SIDE SWALE SCALE 1:20