

INTRODUCTION TO THE CONTEXT

PUBLIC INTEREST DESIGN

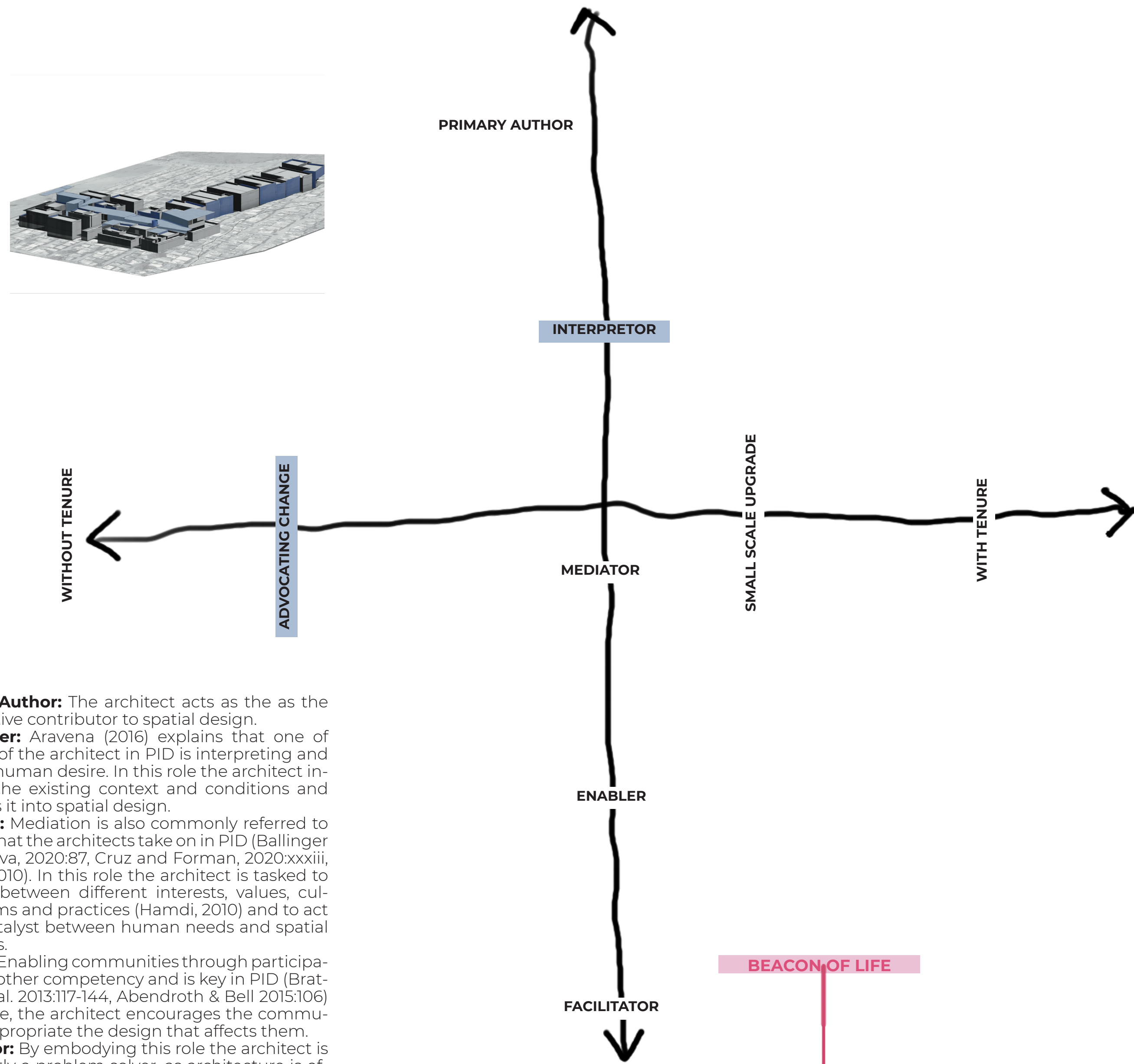

Primary Author: The architect acts as the single active contributor to spatial design.
Interpreter: Aravena (2016) explains that one of the roles of the architect in PID is interpreting and fulfilling human desire. In this role the architect interprets the existing context and conditions and translates it into spatial design.
Mediator: Mediation is also commonly referred to as a role that the architects take on in PID (Ballinger and D. Silva, 2020:87, Cruz and Forman, 2020:xxxiii, Hamdi, 2010). In this role the architect is tasked to mediate between different interests, values, cultural norms and practices (Hamdi, 2010) and to act as the catalyst between human needs and spatial outcomes.
Enabler: Enabling communities through participation is another competency and is key in PID (Brateteig et al. 2013:117-144, Abendroth & Bell 2015:106). In this role, the architect encourages the community to appropriate the design that affects them.
Facilitator: By embodying this role the architect is not directly a problem solver, as architecture is often understood outside of PID, but is instead the facilitator of problem solving (Ballinger & D. Silva 2020:87, Kim 2018:89, Pasel & Skambas 2020:70, Straus and Doyle 1978).

INFORMANTS FROM SITE

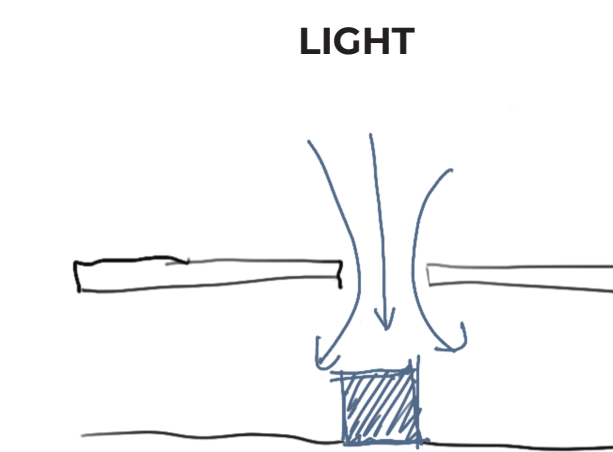
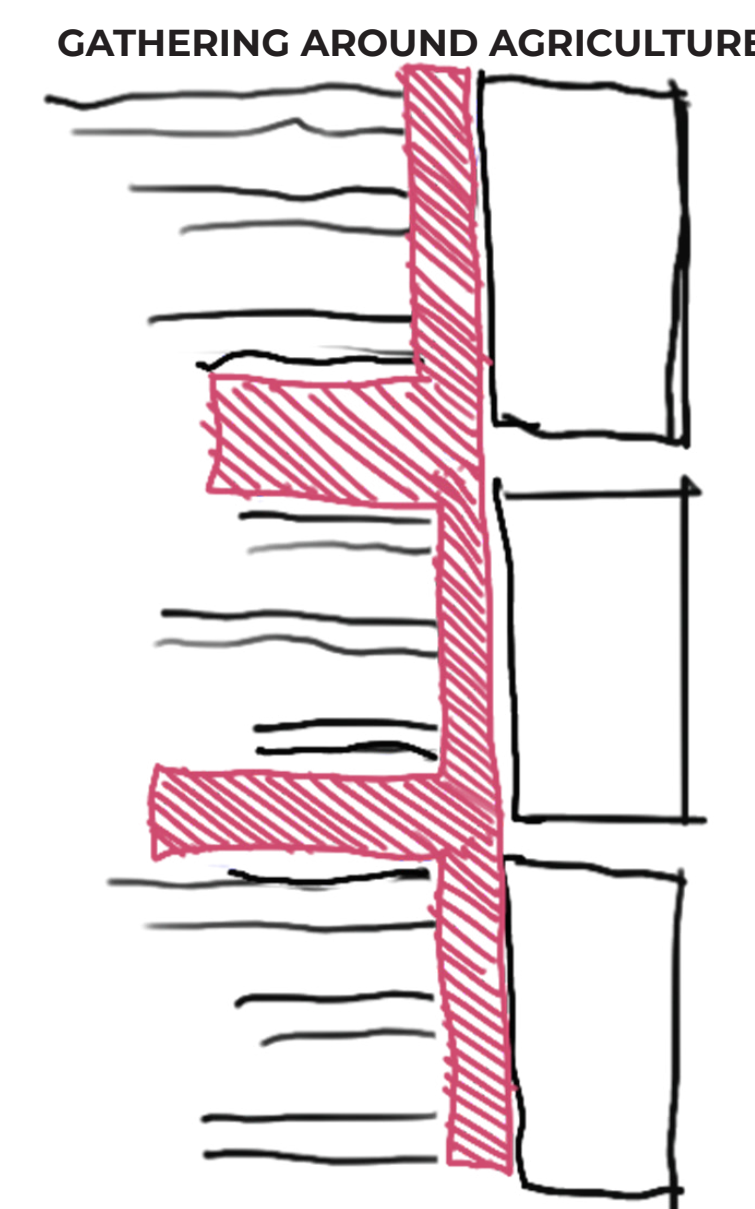
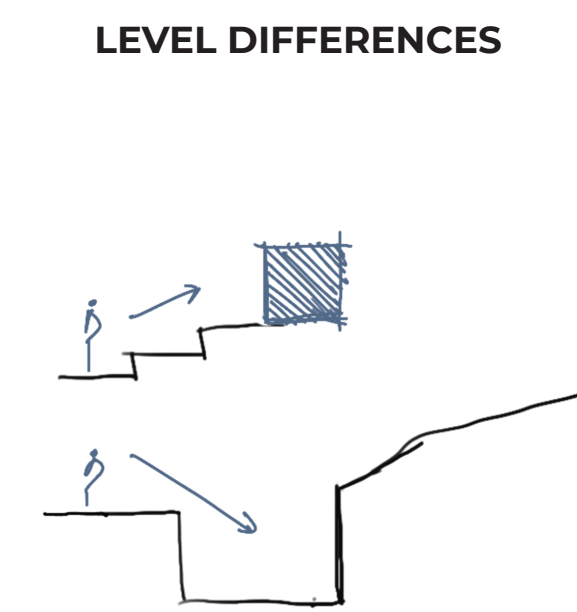
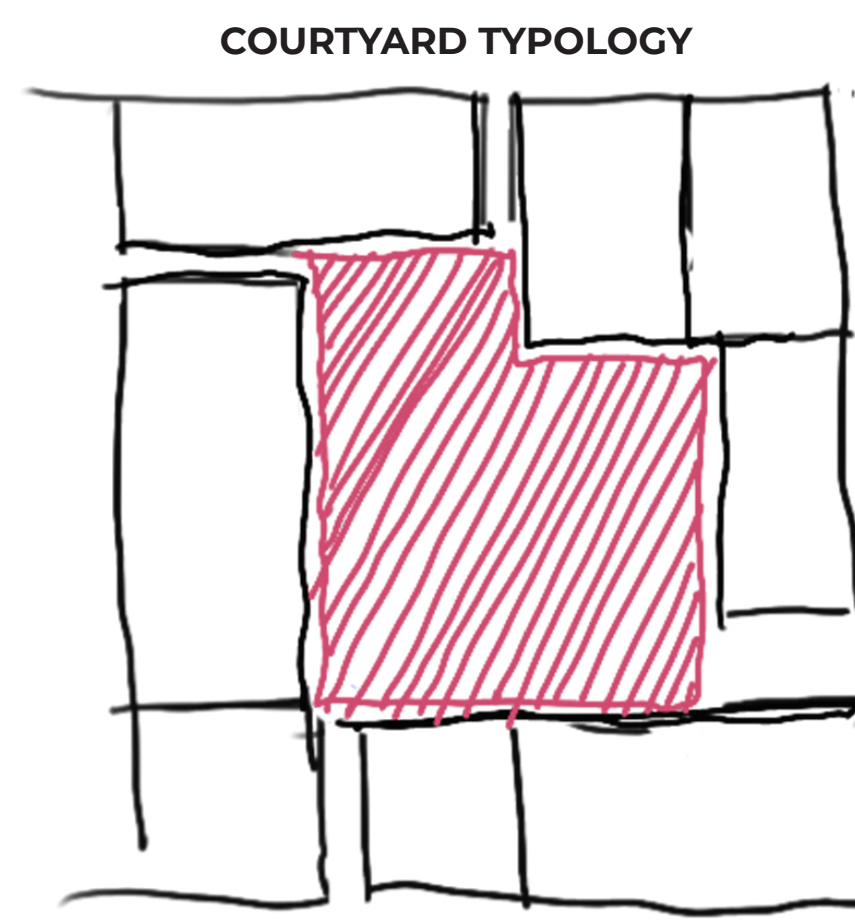
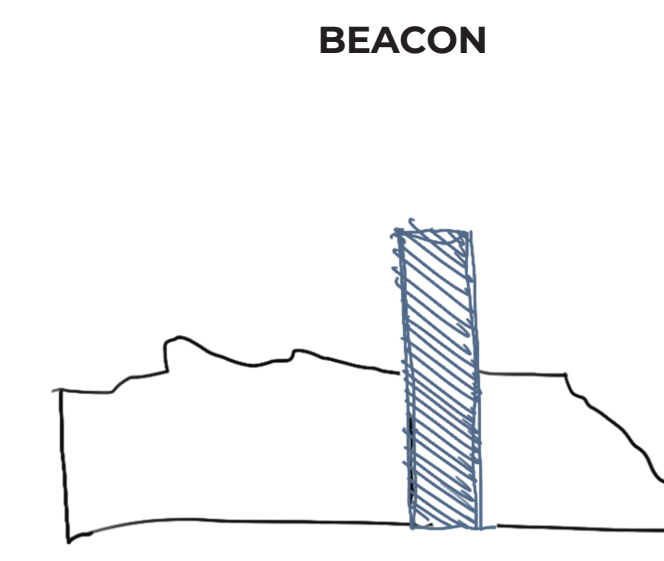
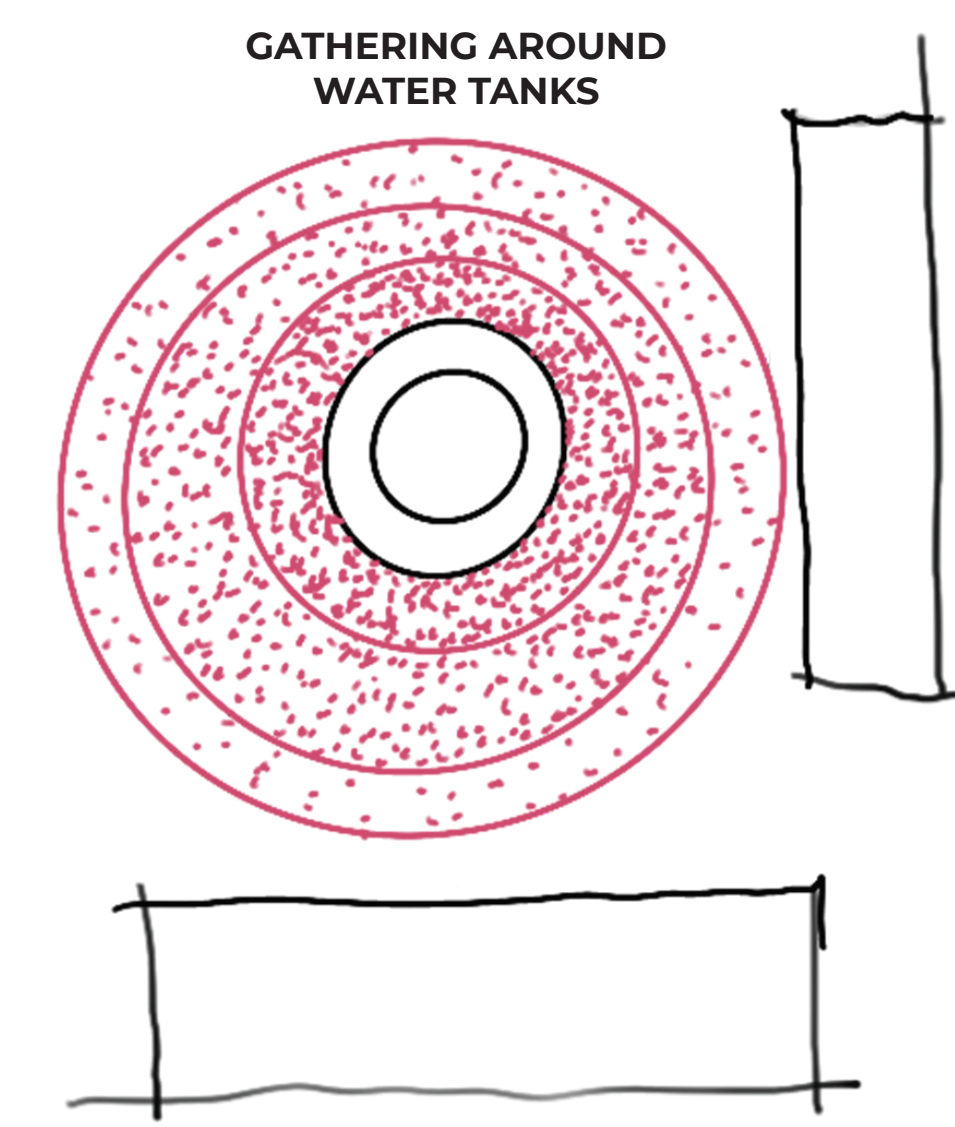

PALIMPSEST

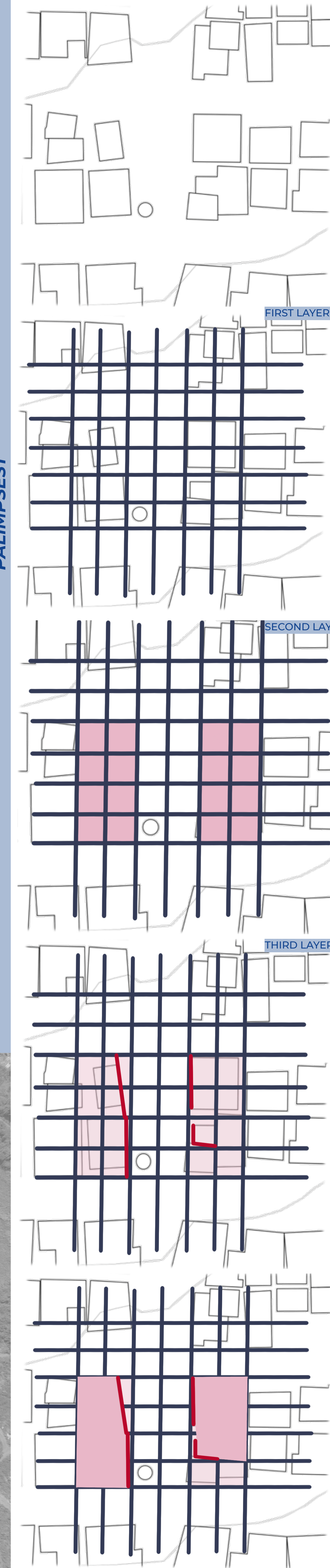

SIGNIFICANCE OF THE WATER TANKS



KEY THEORY AND INFORMANTS

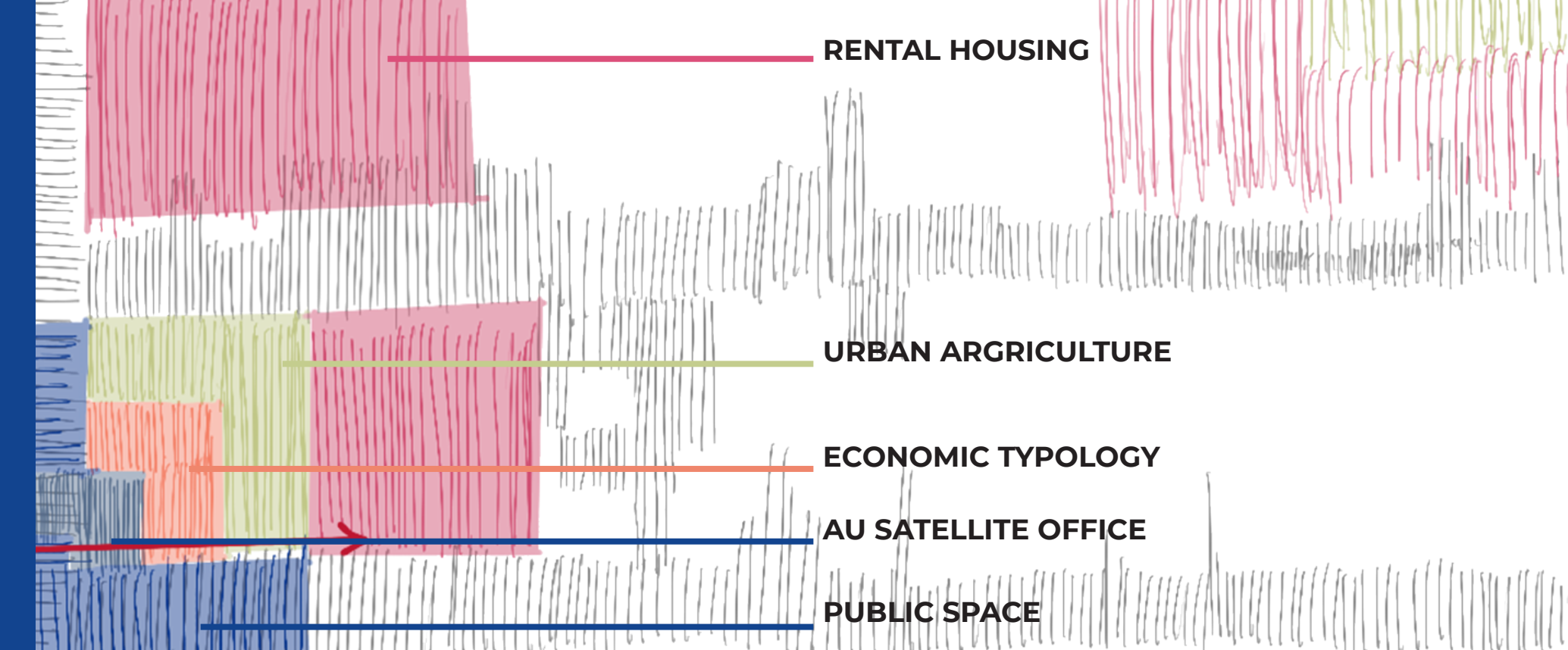
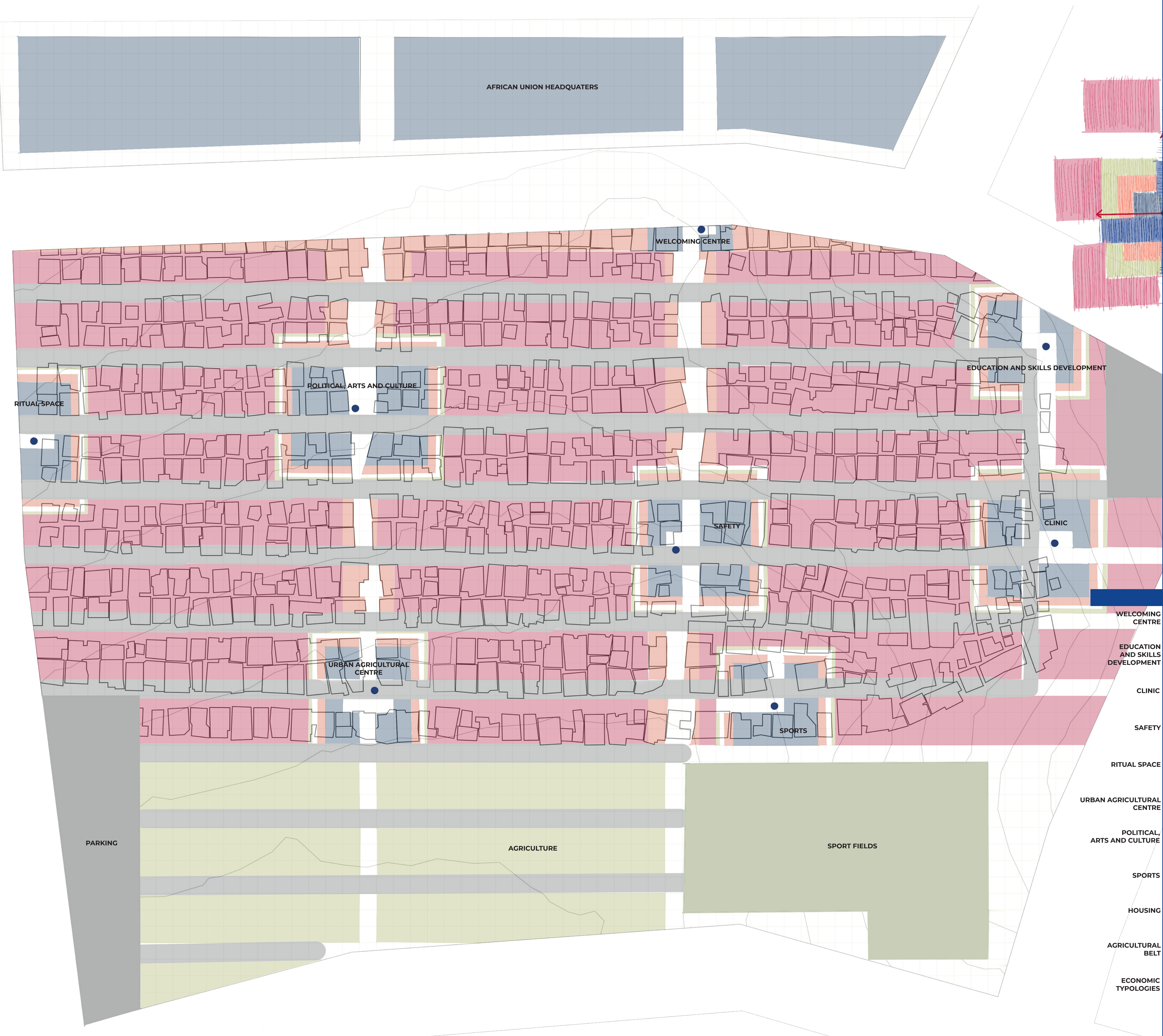

MIGRANTS NEEDS ACCORDING TO THE SOUTH AFRICAN HUMAN RIGHTS COMMISSION:

AFRICAN UNION'S NATIONAL AND REGIONAL PRIORITY AREAS:

USE OF WATER TANKS CURRENTLY IN WOODLANE VILLAGE:

CO-CREATING WELLNESS:

		GATHERING	
BASIC EDUCATION	HUMAN CAPITAL DEVELOPMENT EMPLOYMENT GENERATION ESPECIALLY THE YOUTH AND FEMALES	GATHERING	EDUCATION
HEALTH CARE	SOCIAL PROTECTION	GATHERING	HEALTH CARE
	GENDER/ WOMEN DEVELOPMENT AND YOUTH EMPOWERMENT PEACE AND SECURITY	GATHERING PLAY SCAPE	SAFETY
		GATHERING POINT OF RITUAL	THE IMPORTANCE OF THE CHURCH
	HUMAN CAPITAL DEVELOPMENT AGRICULTURE/ VALUE ADDITION AND AGRO-BUSINESSES DEVELOPMENT	GATHERING	
LEGAL AID	SOCIAL PROTECTION	POLITICAL NODES GATHERING	GATHERING SPACES ON THE SPORTS FIELD OR THE COMMUNITY HALL STRUGGLE OF GETTING RESIDENCY
	CULTURE, ARTS AND SPORTS	GATHERING BEACON OF LIFE	THE IMPORTANCE OF SPORTS IN THE COMMUNITY
BASIC SERVICES ADEQUATE HOUSING		THE NEED FOR BASIC SERVICES	THE NEED FOR BASIC SERVICES
		AGRICULTURE/ VALUE ADDITION AND AGRO-BUSINESSES DEVELOPMENT SUSTAINABLE AND INCLUSIVE ECONOMIC GROWTH	
		HUMAN CAPITAL DEVELOPMENT EMPLOYMENT GENERATION ESPECIALLY THE YOUTH AND FEMALES	THE NEED FOR FINANCIAL SECURITY (ENTREPRENEURSHIP)

1 : 1000

MASTERPLAN